

**GPA WITH COLLAR/GRUBSCREW DRIVE**

GROUP No.	REF. FACE SIZE	A	B	C	D	E	L1	L2a	L3a
1	72 x 82	31.00 TO 51.00	99.0	102.0	129.0 TO 151.0	170.0	18.0	31.5	76.7
2	103 x 113	52.00 TO 85.00	135.0	139.0	165.0 TO 197.0	216.0	20.0	37.0	98.0
3	132 x 144	86.00 TO 105.00	170.0	175.0	205.0 TO 222.0	241.0	20.0	40.0	107.0
4	160 x 178	106.00 TO 138.00	203.0	209.0	239.0 TO 265.0	285.0	27.0	49.0	125.0
5	211 x 229	139.00 TO 180.00	258.0	266.0	300.0 TO 328.0	349.0	27.0	51.0	134.0

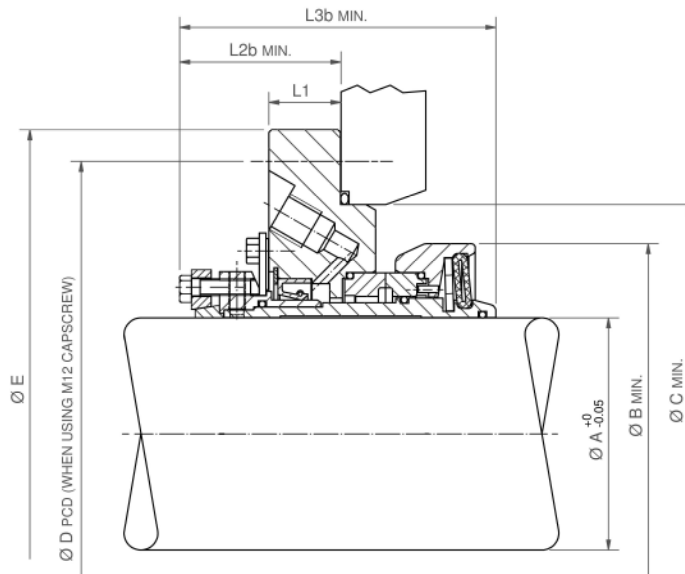

**GPA WITH CONICAL RING/FLANGE DRIVE**

GROUP No.	REF. FACE SIZE	A	B	C	D	E	L1	L2b	L3b
1	72 x 82	31.00 TO 51.00	99.0	102.0	129.0 TO 151.0	170.0	18.0	47.0	90.0
2	103 x 113	52.00 TO 85.00	135.0	139.0	165.0 TO 197.0	216.0	20.0	53.0	112.0
3	132 x 144	86.00 TO 105.00	170.0	175.0	205.0 TO 222.0	241.0	20.0	57.0	121.0
4	160 x 178	106.00 TO 138.00	203.0	209.0	239.0 TO 265.0	285.0	27.0	66.0	141.0
5	211 x 229	139.00 TO 180.00	258.0	266.0	300.0 TO 328.0	349.0	27.0	68.5	149.5

**GARLOCK SEALING TECHNOLOGIES,**  
 Unit 6, 165 Rookwood Rd.,  
 YAGOONA, NSW 2199, AUSTRALIA.  
 PHONE: +61 2 9793 2511  
 E-MAIL: email@garlock.com.au

FAX: +61 2 9793 2544  
 Website: www.garlock.com.au

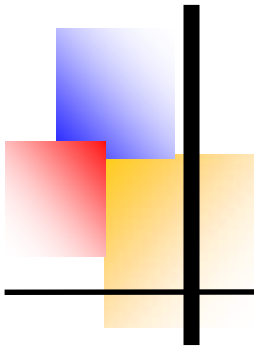

# SLURRY SEAL

## TYPE GPA<sup>®</sup>-S



The Type GPA<sup>®</sup>-S single, balanced cartridge seal is a heavy duty slurry seal, designed to operate in the most arduous slurry applications without flush. The unique diaphragm spring or membrane provides a simple, trouble free, non clogging design, that increases seal reliability.

No flush capability, increases plant efficiency, reduces operating costs and eliminates product contamination.

This is the entry level, single GPA<sup>®</sup> cartridge slurry seal which forms the backbone of the time proven GPA<sup>®</sup> range. It is designed to fit directly into Warman, Denver Orion and similar pumps found in the heavy slurry pump market, using a suitable seal adaptor plate.

Standard arrangement uses grubscrews to provide drive from the pump sleeve. Depending on the seal size, the potential to supply with a cone ring drive is also an option

The Type GPA<sup>®</sup>-S seal can be upgraded to the Type GPA<sup>®</sup>-U, high performance lipseal or the Type GPA<sup>®</sup>-V, V-seal assembly, should a more controlled environment be required.

The seal is suitable for use in the Coal Mining, Mineral Processing, Chemical Process, Power Generation, Steel Production, Pulp & Paper and Sugar Refining industries where extreme slurry sealing applications demand a rugged uncompromising sealing solution.

<b>Materials of Construction:</b>	
Rotary Face:	Silicon carbide, Tungsten carbide
Stationary Seat:	Silicon carbide, Tungsten carbide
Static Packing:	Viton, HNBR, Teflon, Aflas,
Metal Parts:	Duplex stainless steel (std) Options available include CD4MCu.
<b>Operating Envelope:</b>	
Pressure:	20 bar g / 300psi
Speed:	20 m/s
Temperature:	0 to 80°C without quench
Duty:	Slurry solids up to 60% by weight

